

SHRI VASANTRAO BANDUJI PATIL TRUST'S
**APPASAHEB BIRNALE COLLEGE OF
ARCHITECTURE, SANGLI**

(Approved by AICTE, C.O.A New Delhi, Affiliated to Shivaji University Kolhapur)
South Shivajinagar, Sangli Miraj Road, Sangli-416146. Ph. No- (0233) 2320294, 2322336.

Website- www.abcasangli.edu.in Affiliated: Shivaji University Kolhapur

Principal: - Dr. Arundhati P Wategave Ph.D.

**Infrastructure and Learning
Resources**

Library as a Learning Resource

1. About Library



Arundhati P Wategave
VC. PRINCIPAL,
APPASAHEB BIRNALE COLLEGE
OF ARCHITECTURE, SANGLI.



SHRI VASANTRAO BANDUJI PATIL TRUST'S
**APPASAHEB BIRNALE COLLEGE OF
ARCHITECTURE, SANGLI**

(Approved by AICTE, C.O.A New Delhi, Affiliated to Shivaji University Kolhapur)
South Shivajinagar, Sangli Miraj Road, Sangli-416146. Ph. No- (0233) 2320294, 2322336.

Website- www.abcasangli.edu.in Affiliated: Shivaji University Kolhapur

Principal: - Dr. Arundhati P Wategave Ph.D.

CONTENT

SR. NO	DESCRIPTION
4.2	About Library
4.2.1	Report on Integrated Library Management System (ILMS)
4.2.2.	Subscription For e – resources
4.2.3.	Expenditure for purchase of books/ e-books and subscription to journals/e- journals
4.2.4.	Per Day Usage of Library
	Library Layout , Photos of Library Zone & Event



Arundhati P Wategave

**I/C. PRINCIPAL
APPASAHEB BIRNALE COLLEGE
OF ARCHITECTURE, SANGLI**

4.2 LIBRARY AS A LEARNING RESOURCE

4.2. Library is automated using Integrated Library Management System (ILMS), subscription to e resources, amount spent on purchase of books, journals and per day usage of library

Response:

About Library:

Library is spacious and well-furnished with total built-up area 118 Sq. M. including reading room with the seating capacity of 80 users. The library is well furnished with abundant sunlight and natural ventilation. The Library seeks to prepare students for lifelong learning by providing a good number of print & electronic scholarly resources in the field of architecture. The library has well equipped with different sections for regular administration i.e. Issue-Return, Stacking Area, Reading Hall, Newspaper & Periodical section, Digital Library section, and Property counter. Robust security measures, including CC cameras and fire extinguishers, are in place to safeguard the valuable resources and maintain a conducive learning atmosphere.. Library has 6 computers, a LaserJet printer, a barcode printer with barcode scanners for in-house operations.

ABCA Library has a treasure house of Books, Print journals, e-journals, e-books and e-resources. The library has a huge stock of More than **6800 books**, including text books, reference books, encyclopedias, dictionaries as well as **873 architectural project /Thesis reports, research reports, Print journals with 705 bound volumes, newspapers, and audio-visual materials**, are available in the library. It has **Wi-Fi and excellent IT capabilities**. Architecture Library has an excellent digital library section with access to **e – resources**. Number of a special & Rare Books collection available at the library. The library provides open access to its reference section and any member can browse through the collections which are arranged according to **Dewey Decimal Classification (DDC)**.

To inculcate reading habits among students, the library organizes different activities & days celebration. To make the Students & Staff members aware with the library resources & services Library conducts user orientation program. Now Library has started initiated additional book issuing facility for the topper & best reader students. Library is automated using **e - Vidya (ACE) Library Management System**.

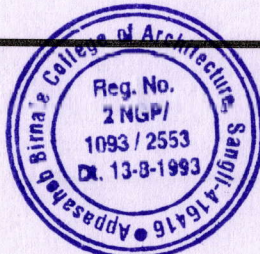

Appasaheb
I/C. PRINCIPAL
APPASAHEB BIRNALE COLLEGE
OF ARCHITECTURE, SANGLI

Library Advisory committee 2023-2024

Chairman	Dr. A. P. Wategave	Principal
Secretary	Ms. S. S. Sungare	Librarian
Assistant Librarian	Mr. S. T. Patil	Asst. Librarian
Members	Ar. S. P. Jagtap Ar. Kishori Mohite Ar. Nandinee Kulkarni Mr. Vikram Patil Mr. Vishav V. Mangave Ms. Vaishanvi Matthe	(Staff) (Staff) (Staff) (Staff) (Student) (Student)

Library Advisory committee plays vital role in the quality and relevance of library services in any educational, research, or organizational setting and development.

1. Developing and implementing processes to ensure the library's seamless operation.
2. Identifying and purchasing different sorts of books.
3. Budget allocation, policy decisions, rule formation, and execution.
4. Orientation sessions for newly enrolled students to the institute.
5. OPAC, National Digital Library (NDL), K-HUB, and other e-journals awareness workshops.
6. To conduct activities like the celebration of anniversaries of great Indian personalities and training sessions on access to e-resources in online and offline mode.
7. Exhibition of New Book arrivals in the library.

A. P. Wategave

**I/C. PRINCIPAL
APPASAHEB BIRNALE COLLEGE
OF ARCHITECTURE, SANGLI**



LIBRARY SERVICES & FACILITIES:

Library provides Open access to all, Reprographic Service, Internet Facility, Wi-Fi facility, Circulation Service, Reference service, Current Awareness Service, New Arrival display, Question bank service to the users. Inter library loan service to outsider users. Reference alone facility has been extended to NATA, NASA and alumni students of the institute.

LIBRARY BEST PRACTICES:

Library Automation.
Display of Unique Images.
Display New Arrivals.
Rare & special collection.
e- Library (FTP Server) Collection.
Librarian's Day Celebration.
Best Library User Award.
Receiving suggestions & feedback from user.

INSTITUTIONAL MEMBERSHIP/SUBSCRIPTION:

Library has institutional membership of, K-Hub Architecture e-library, NPTEL Local Chapter & NDL.

DETAILS OF LIBRARY

Total Area of Library(In Sq.m)	118 Sq.m
Working Hours	8 hrs
Working Hours (Monday to Saturday)	8.30am to 5.30pm
On Holidays	Closed
During Examination days	Same as working days

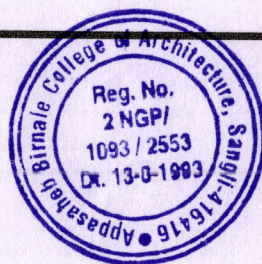

Appasaheb Birnale
I/C. PRINCIPAL
APPASAHEB BIRNALE COLLEGE
OF ARCHITECTURE, SANGLI

(ILMS) INTEGRATED LIBRARY MANAGEMENT SYSTEM:

Library automation: Library is automated using the Integrated Library Management System (ILMS).

The library is automated with Cloud Based e-vidya ACE LMS 2.1 software. e-vidya – (ACE) LMS (Version2.1) developed by Biyani Technologies software Development Company, Kolhapur, Since 2014.

Software consists of Acquisition, Circulation, Cataloguing, Serial Control etc. module.

Through these modules, various activities of the library such as data entry, billing, circulation, cataloging etc. are done.

All the books are barcoded using software.

Webopac is available on college website by which any one can search resources by title, author, subject, and acc_no.

Reader gets information about new arrivals through WEB OPAC.

DETAILS OF ILMS SOFTWARE

ACADEMIC YEAR	NAME OF ILMS SOFTWARE	NATURE OF AUTOMATION	VERSION
2014-2021	e-Vidya	Partially	
2023-2024	e-Vidya (ACE LMS Web)	Partially	LMS 2.1

- **Name of ILMS software: e- VidyaACE Library Management System.**
- **Nature of automation: partial Automation**
- **Version: e- vidya LMS 2.1**
- **Year of automation: 2014-15**
- **New Version: e –vidya (LMS-2.1 web Base)**



**I/C. PRINCIPAL
APPASAHEB BIRNALE COLLEGE
OF ARCHITECTURE, SANGLI**

THE INSTITUTION HAS ACCESS TO THE FOLLOWING: E-RESOURCES

E-RESOURCES	SUBSCRIPTION / MEMBERSHIP	AMOUNT
e- Journals	K- Hub, Subscription	37760
e- Books	K- Hub, Subscription	
e-ShodhSindhu	no	0
Shodhganga Membership	Open Access	0
Database	e-Library College private Membership	2360
Local and / or Remote access to library	OPAC, e-Library College private Membership	0

Library provides the e-Resources facility with the Subscription / membership of K-hub, Database. This has 4616+ e-data with e-Journals, e-Books, Videos, & other. Separate ID and Password provided to the user to access e-books, e-Journals, e- library data. Total Rs.40120/- spent on e-resources, Average Expenditure of e – Journals of Library for the year 2023-2024 - Average In lakhs = 0.40

AMOUNT SPENT ON PURCHASE OF BOOKS, SUBSCRIPTION OF JOURNALS & e- JOURNALS

During the last Year 2023 - 2024 (INR in Lakhs) 2.78

Year of Expenditure	Expenditure on Purchase of Books	Expenditure on Purchase of Journals	Expenditure on Purchase of e - Resources	Total
2023-2024	167718	70350	40120	278188

PER DAY USAGE OF LIBRARY (FROM 01/06/2023 TO 31/05/2024)

Academic Year	Total Usage	Library Working Day	No. of User	Per day Usage	% of usage
2023-2024	20011	274	224	73.328	32.603



Appasaheb Birnale
I/C. PRINCIPAL
APPASAHEB BIRNALE COLLEGE
OF ARCHITECTURE, SANGLI

LIBRARY LAYOUT & PHOTOS OF LIBRARY ZONE

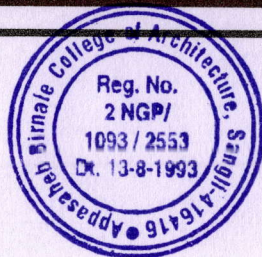
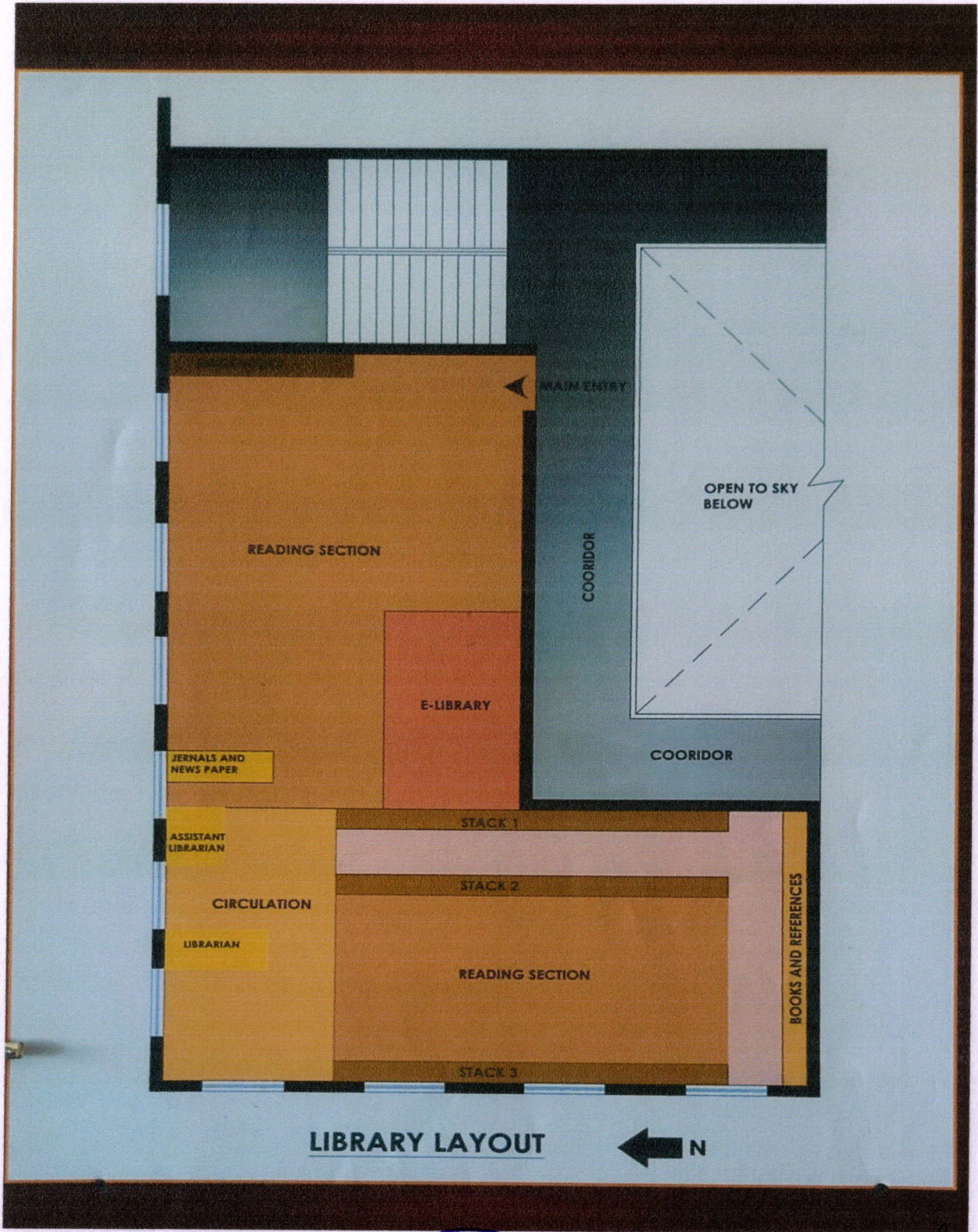

Appasaheb Birnale
I/C. PRINCIPAL
APPASAHEB BIRNALE COLLEGE
OF ARCHITECTURE, SANGLI

E - LIBRARY ZONE

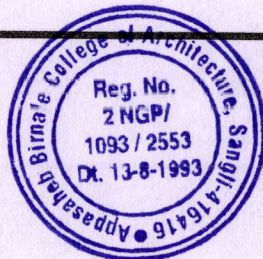
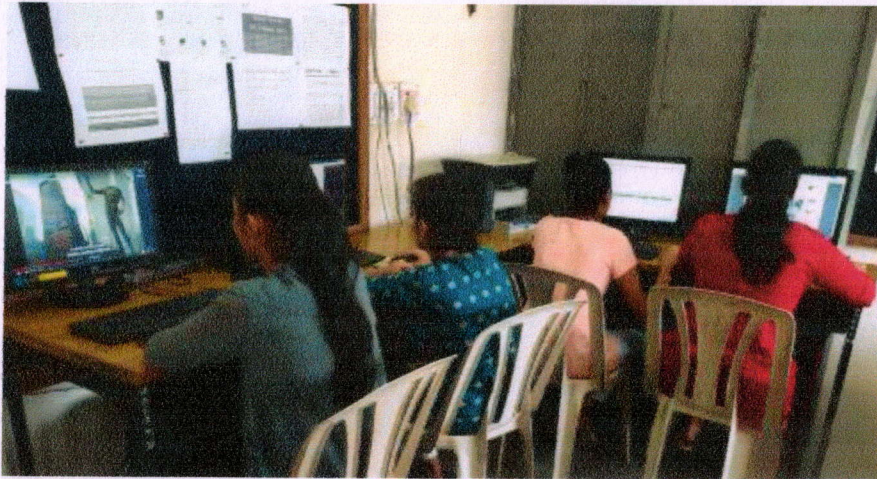
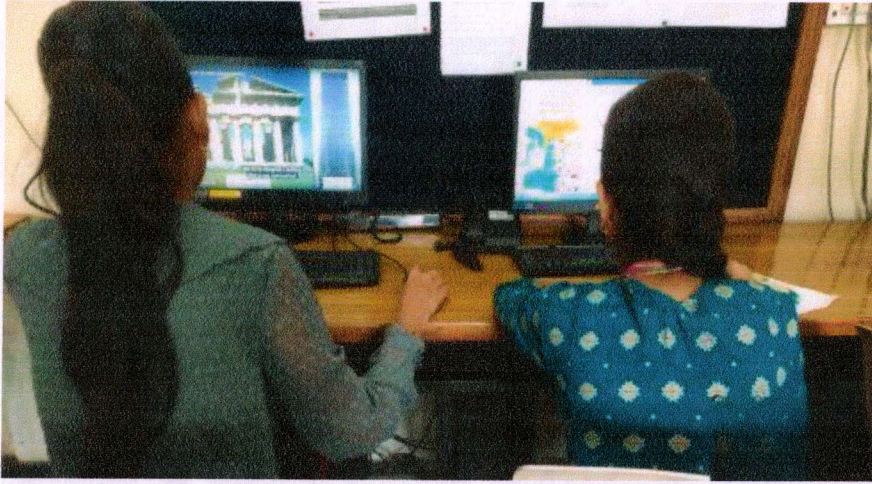

Appasaheb

**I/C. PRINCIPAL
APPASAHEB BIRNALE COLLEGE
OF ARCHITECTURE, SANGLI**

MAGAZINE / JOURNALS ZONE



LIBRARY CIRCULATION ZONE

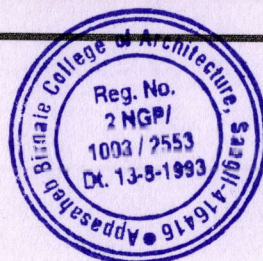

Principle
**I/C. PRINCIPAL
APPASAHEB BIRNALE COLLEGE
OF ARCHITECTURE, SANGLI.**

LIBRARY READING ZONE



LIBRARY REFERENCE ZONE



Appasaheb
I/C. PRINCIPAL
APPASAHEB BIRNALE COLLEGE
OF ARCHITECTURE, SANGLI.

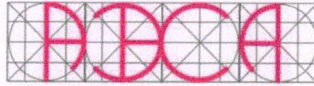

SHRIVASANTRAOBANDUJIPATILTRUST'S

APPASAHEB BIRNALE COLLEGE OF ARCHITECTURE, SANGLI

(Approved by AICTE, C.O.A New Delhi, Affiliated to Shivaji University Kolhapur)
South Shivajinagar, Sangli Miraj Road, Sangli-416146. Ph.No-(0233)2320294, 2322336.

Website-www.abcasangli.edu.in Affiliated: Shivaji University Kolhapur

Principal:-Dr.ArundhatiPWategavePh.D.

World Book Day and Copyright Day Celebration

Event

Tuesday – 23rd April, 2024 Time -12.15 PM -1.00 PM

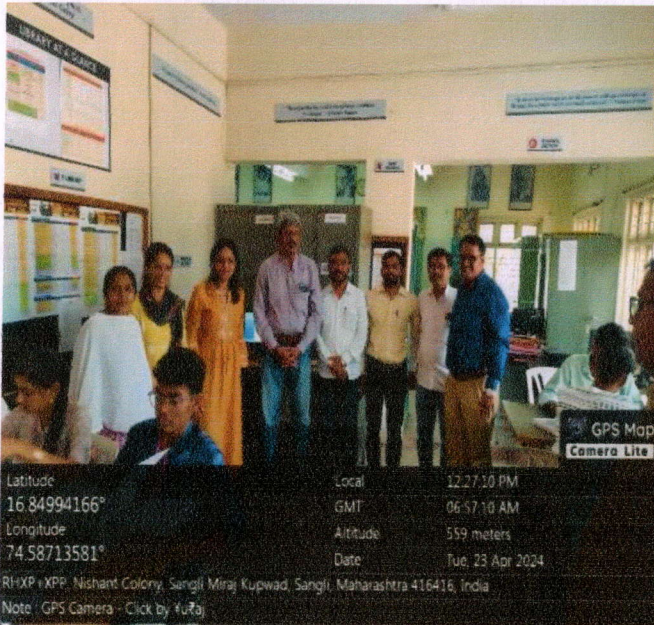

Latitude: 16.84994166°
Longitude: 74.58713581°
Local: 12:27:30 PM
GMT: 06:57:10 AM
Altitude: 559 meters
Date: Tue, 23 Apr 2024
RH:XP: XPP, Nishant Colony, Sangli Miraj Kupwad, Sangli, Maharashtra 416416, India
Note: GPS Camera - Click by YuJa

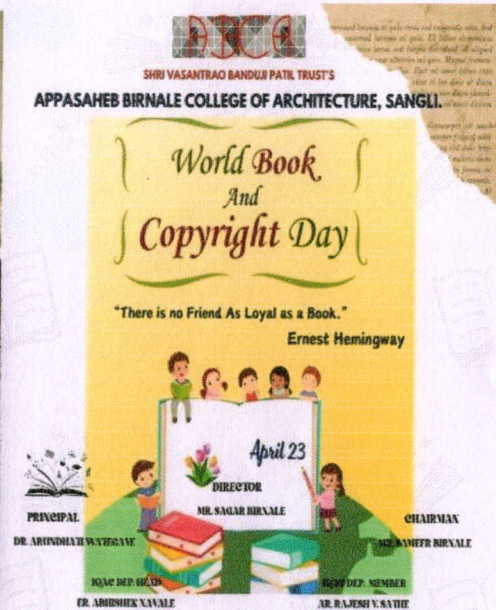

Appasaheb Birnale College of Architecture, Sangli Celebrates World Book Day and World Copyright Day with Book Donation and Financial Learning Focus



Arundhati
I/C. PRINCIPAL
APPASAHEB BIRNALE COLLEGE
OF ARCHITECTURE, SANGLI.

This event was a way to celebrate reading books and importance of books and to learn about importance of resource and financial management in the world of architecture.



Latitude 16.8499195° Longitude 74.5871952° Local 12:27:53 PM GMT 06:57:53 AM Altitude 559 meters Date Tue, 23 Apr 2024
 RHXP + XPP, Nishant Colony, Sangli Miraj Kupwad, Sangli, Maharashtra 416416, India
 Note : GPS Camera - Click by YuRaJ

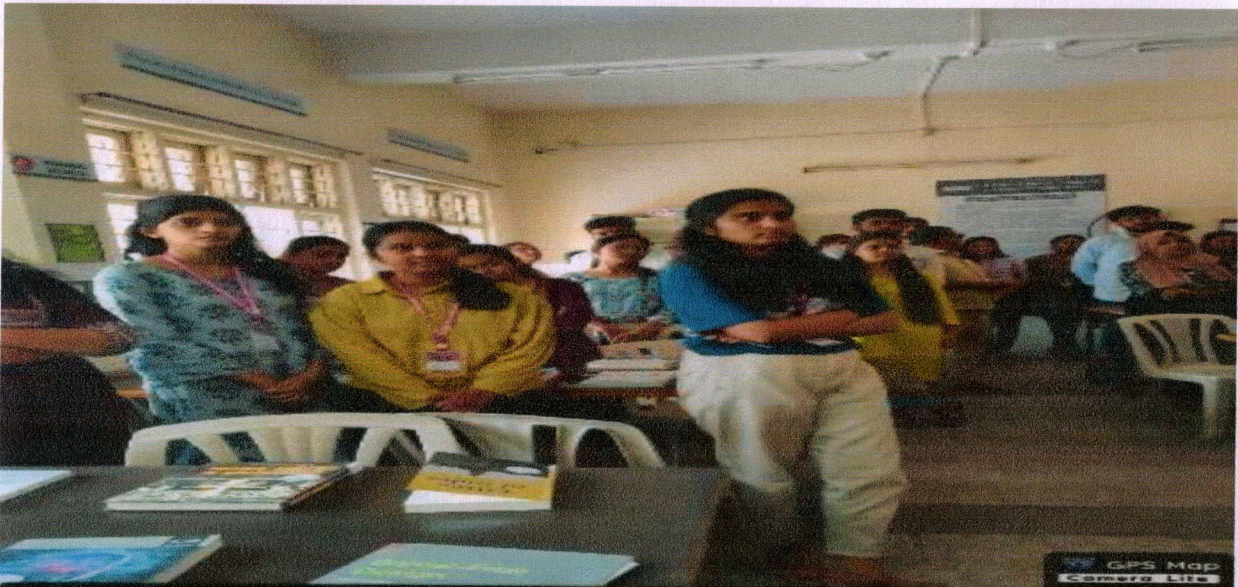

Latitude 16.84995753° Longitude 74.58716082° Local 12:28:48 PM GMT 06:58:48 AM Altitude 559 meters Date Tue, 23 Apr 2024
 RHXP + XPP, Nishant Colony, Sangli Miraj Kupwad, Sangli, Maharashtra 416416, India
 Note : GPS Camera - Click by YuRaJ



Ananya
 I/C. PRINCIPAL
 APPASAHEB BIRNALE COLLEGE
 OF ARCHITECTURE, SANGLI

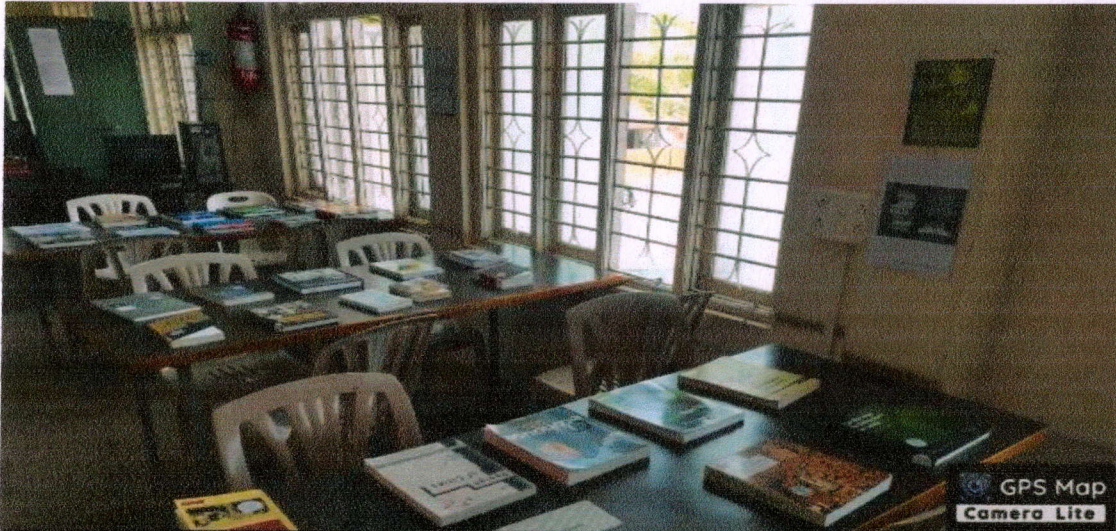

Latitude 16.84950369° Longitude 74.58715097° Local 12:42:34 PM GMT 07:12:34 AM Altitude 559 meters Date Tue, 23 Apr 2024

Oppo. Birnale Architecture College Second Floor, above Janklyan Bank, Nishant Colony, Sangli, Sangli Miraj Kupwad, Maharashtra 416416, India

Note : GPS Camera - Click by ₹uṚaj

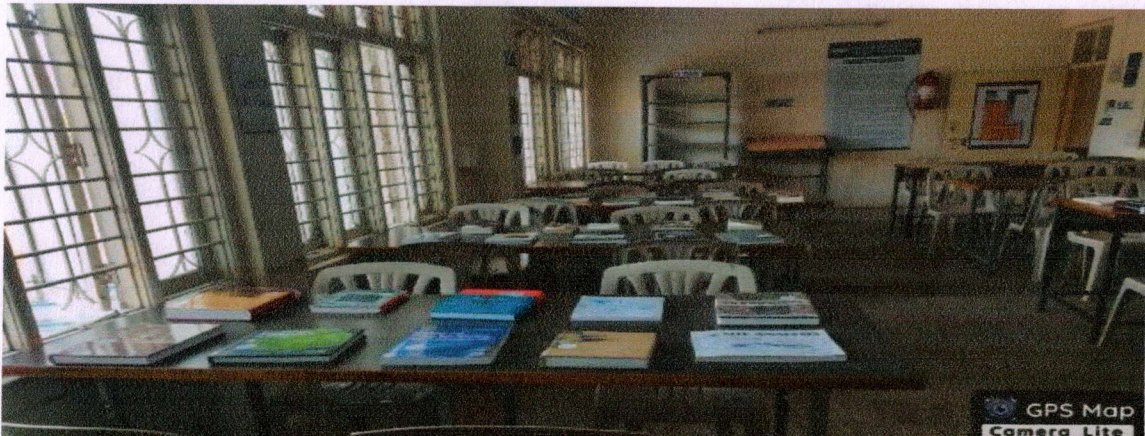

Latitude 16.84950369° Longitude 74.58715097° Local 12:42:01 PM GMT 07:12:01 AM Altitude 559 meters Date Tue, 23 Apr 2024

Oppo. Birnale Architecture College Second Floor, above Janklyan Bank, Nishant Colony, Sangli, Sangli Miraj Kupwad, Maharashtra 416416, India

Note : GPS Camera - Click by ₹uṚaj



Apurva
I/C. PRINCIPAL
APPASAHEB BIRNALE COLLEGE
OF ARCHITECTURE, SANGLI

Renowned Architect and Alumni of Appasaheb Birnale College of Architecture, Ar. Sachin Kanoje Sir generously donated some important books to the college library

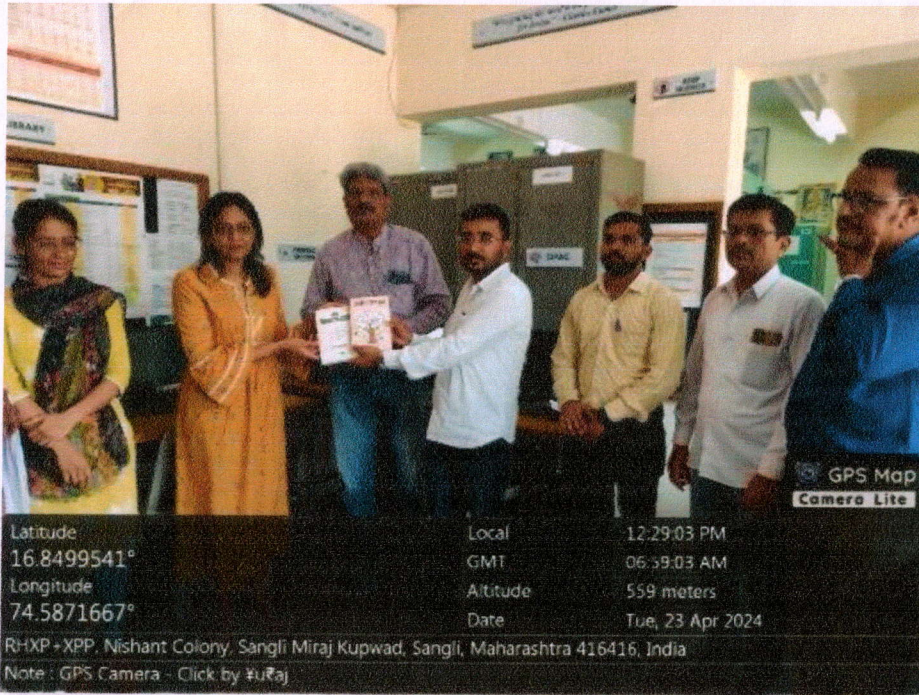

Aratigme

**I/C. PRINCIPAL
APPASAHEB BIRNALE COLLEGE
OF ARCHITECTURE, SANGLI.**